

PUTNEY WOODS

Metcalfe Trust Land
Langley, WA
Whidbey Island

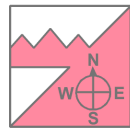

Cascade
Orienteering Club
www.CascadeOC.org



- Half, Marathon loop route
- 10k route
- 5k route

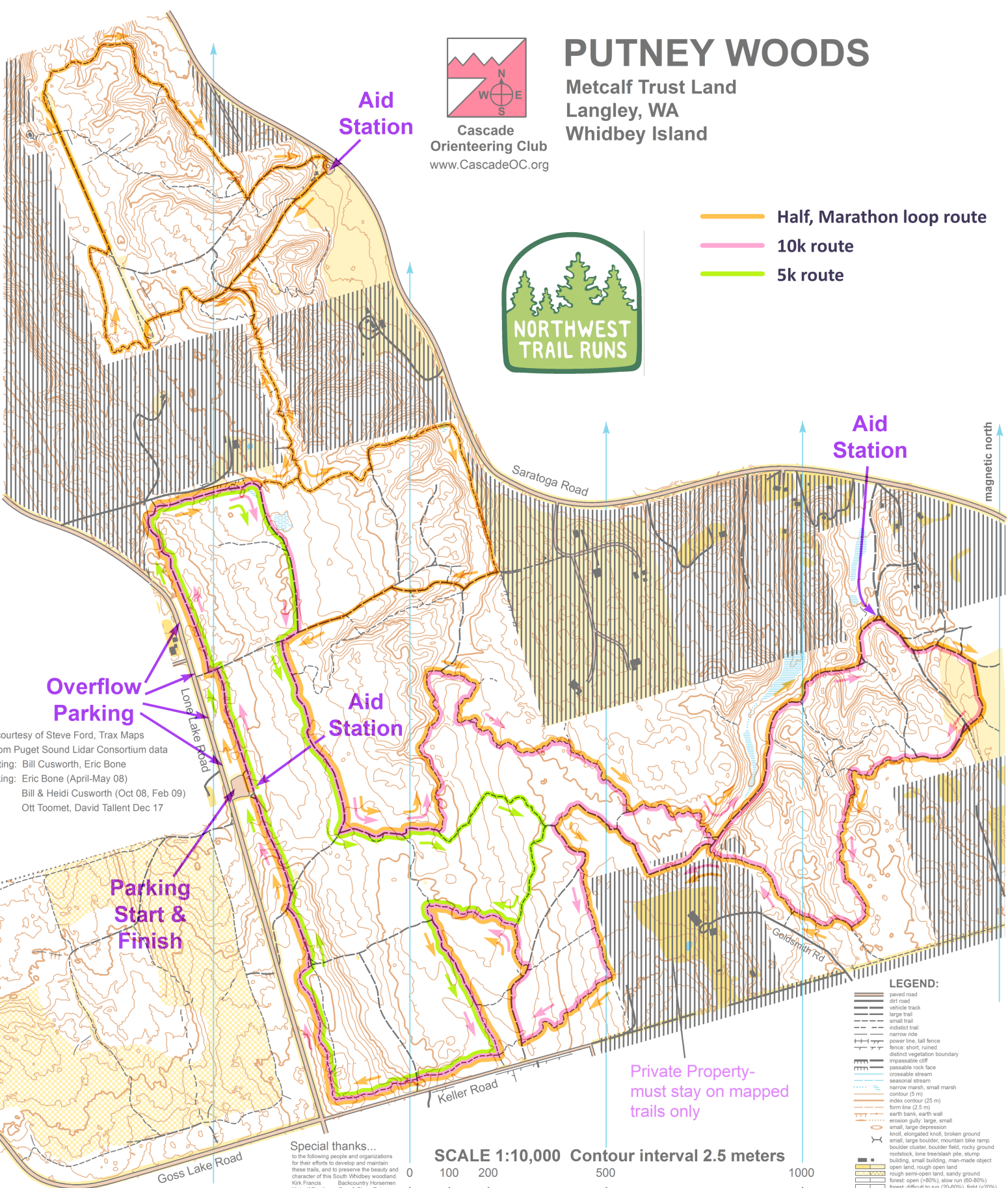

Courtesy of Steve Ford, Trax Maps
from Puget Sound Lidar Consortium data
Mapping: Bill Cusworth, Eric Bone
Editing: Eric Bone (April-May 08)
Bill & Heidi Cusworth (Oct 08, Feb 09)
Ott Toomet, David Tallent Dec 17

Overflow
Parking

Parking
Start &
Finish

Aid
Station

Aid
Station

Private Property—
must stay on mapped
trails only

Special thanks...
to the following people and organizations
for their efforts to develop and maintain
these trails, and to preserve the beauty and
character of this South Whidbey woodland.
Kirk Francis Backcountry Horsemen
Metcalfe Family Gary & Diane Putney

SCALE 1:10,000 Contour interval 2.5 meters



SCALE IN METERS

LEGEND:

- paved road
- dirt road
- vehicle track
- large trail
- small trail
- indistinct trail
- narrow ride
- power line, tall fence
- fence: short, ruined
- distinct vegetation boundary
- impassable cliff
- passable rock face
- crossable stream
- seasonal stream
- narrow marsh, small marsh
- contour (5 m)
- index contour (25 m)
- form line (2.5 m)
- earth bank, earth wall
- erosion gully: large, small
- small, large depression
- knoll, elongated knoll, broken ground
- small, large boulder, mountain bike ramp
- boulder cluster, boulder field, rocky ground
- outcrop, lone tree/decid. pile, stump building, small building, man-made object
- open land, rough open land
- rough semi-open land, sandy ground
- forest: open (>80%), slow run (60-80%)
- forest: difficult to run (20-60%), tight (<20%)
- undergrowth: slow run, difficult to run
- lake/river, pond
- marsh: untraversable, crossable
- indistinct marsh, bare rock
- out of bounds, parking / paved area